

## Using Bond It Glassmate AC035 Mirror Adhesive

### Description

A low modulus, neutral cure silicone sealant. Suitable for interior fixing of mirrors, coated glass or metal panels.

A ready to use, one-part silicone sealant which is non-corrosive and odourless. GLASS-MATE has excellent unprimed adhesion on most mirror coatings and has outstanding resistance to heat and humidity. Its properties are unaffected by sunlight, ultra-violet radiation and temperature extremes.

Conforms to ISO11600-G-25LM.

### Uses

Bond It GLASS-MATE is suitable for internal bonding of mirrors, glazed surfaces, ceramics, enamel, metals, PVCu, polycarbonate and treated or untreated wood, to most common substrates.

### Preparation

Ensure all surfaces are clean, dry and free from grease or any contaminants that may hinder adhesion.

### Application

Apply using a standard sealant gun. Cut tip from cartridge, be careful not to damage the screw thread. Cut the nozzle at an angle of 45° and fix to cartridge. Using a caulking gun apply sealant. Extrude 10mm wide strips of sealant vertically to the back of the mirror, or surface to be bonded, approximately 100 apart.

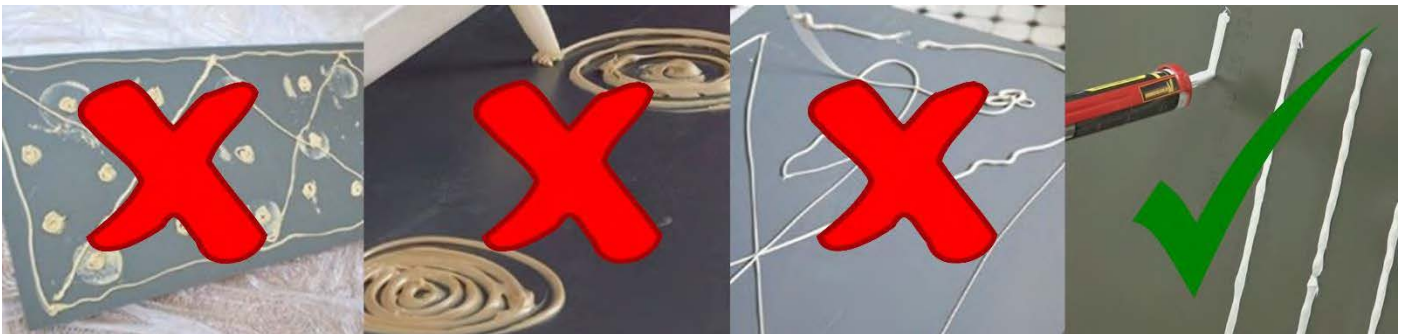

Press the mirror onto the surface being bonded, so that the adhesive becomes a constant bead thickness of 3mm for optimum cure. Mechanically support the mirror once in place for at least 48 hours. For large mirrors this product should be used in conjunction with mechanical fixings. **Within 5 mins of application of adhesive (before surface skin is formed) the mirror has to be fixed to the wall and positioned in place.**

**Note:** this product is not suitable for use as a sole fixing for safety backed mirrors.

Adhesive strength will be build up during this time and maximum strength is achieved after complete cure which might take 5-7 days. If joints between mirrors or mirrors and wall have to be sealed to prevent water penetration behind the mirror it is advisable to do this sealing after the adhesive is fully cured. (If sealing is done too early the adhesive can be shut off from the necessary moisture supply resulting in curing defects). By sealing the joints around the mirror, water penetration through these joints is avoided, however ventilation is stopped as well which implicates that one has to be sure that no water accumulation, behind the mirror, through for instance the substrate can take place

### Limitations

This product should not be used in the manufacture of structural glazing. It is also not suitable for aquarium assembly or for jointing in swimming pools or other submerged applications. We do not recommend that this product be used in food grade applications.

The safety backing on some mirrors is not suitable for adhesive fixing with silicone. Our own tests have shown that premium White safety backing works fine with this mirror adhesive. If any doubts or using your own safety backing ALWAYS carry out an adhesion test first.

#### Container Size

EU3 plastic cartridge.

#### Colours

GLASS-MATE is available in translucent only.

#### Shelf Life

Maximum 12 months in unopened cartridge.

#### Cleaning of Tools

Use white spirit.

#### Storage Conditions

Store in cool, dry conditions.

#### Disposal of Containers

Do not leave empty containers where residue could be harmful to children, animals or the environment. Remove any containers to a central disposal point in accordance with local regulations.

**Health & Safety** Avoid eye contact. Avoid prolonged contact with skin. Thoroughly wash hands with soap and water after use. Keep out of reach of children. See separate material safety data sheet for full handling, use and storage.

### Specification Summary

Skimming Time	Less than 30 minutes
Full Cure	24-48 hours depending on conditions and bead depth
Extensibility	Up to 450% at breaking point
Application Temperature	+5 to + 30°C
Service Temperature	-40 to + 120°C continuous exposure, higher temperatures can be withstood for limited periods
Adhesion	Good to glass, concrete, ceramics, timber, ferrous metals and most building materials

#### Liability

All supplied information is the result of our tests and experience and is of general nature, however they do not imply any liability.

It is the responsibility of the installer to verify by his own tests if the product is suitable for the application.